

PRESIDENTIAL SUITE

Welcome aboard the feeling of your own luxury vessel, with high ceilings and luxury portholes, surrounded with Biscayne Bay and City views featuring two bedrooms, kitchenette and royal table for ten guests, and three private furnished balconies.

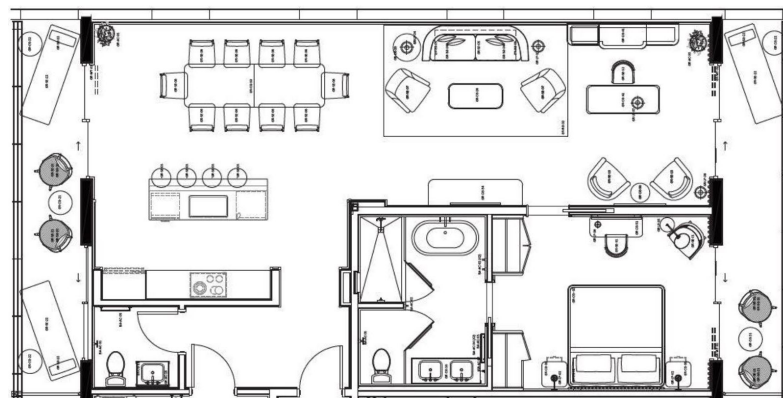

SEATING & CAPACITY

SPACE	SQUARE FOOTAGE	BANQUET	RECEPTION	CLASSROOM	THEATER	U-SHAPE
PRESIDENTIAL SUITE	1,750	18	30	170	280	70